

EMERGENCY BUSHFIRE PLAN

SITE PLAN

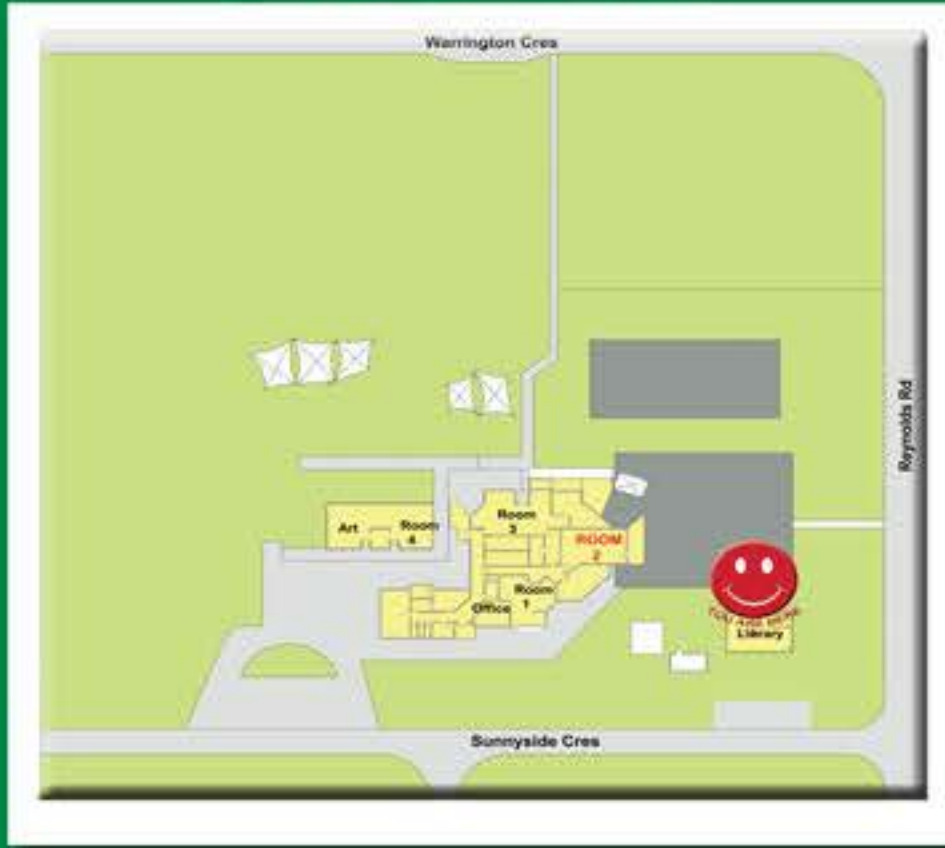

Wattle Glen P.S Reynolds Rd, Wattle Glen. 3096

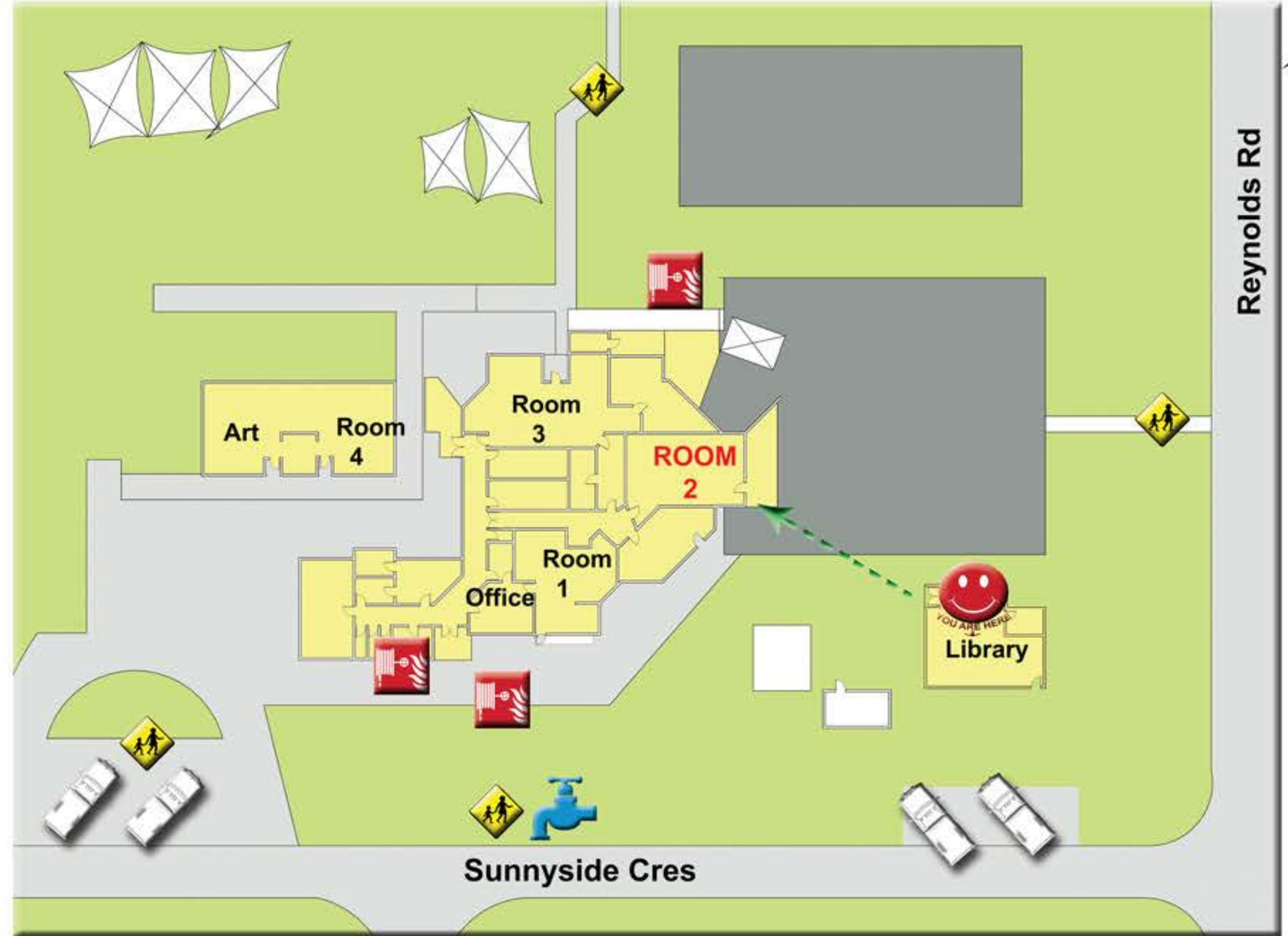

BUSHFIRE PROCEDURE

1. Warning of bushfires is given over PA system via bell, then verbal instructions.
2. Check store room & toilets
3. Turn Off appliances.
4. Close windows & doors
5. Take Emergency Management Folder.
6. **Ensure movement to Room 2.**
7. Await for class teachers & office staff to report in.
8. Contact Emergency Management
Tel: **9589 6266**

LEGEND



EVAC DIRECT

ISSUE DATE: VERSION: VALIDATION DATE: